

A) As supplied

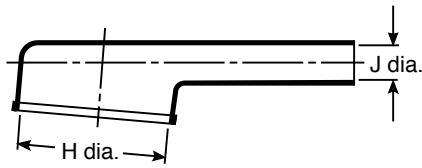

B) After recovery

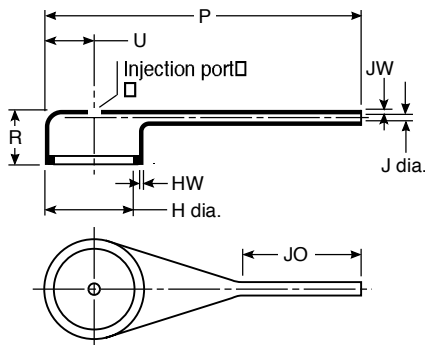

222D921-963

Right angled (90°) high ratio, lipped heat-shrinkable boot

Applications

Used for mechanical protection and cable connector strain relief. Ideal for applications where only a small number of contacts are utilised, resulting in the need for a high ratio boot to match the connector to the cable diameter.

Materials available

- 3 Semi-rigid modified Polyolefin.
- 4 Flexible modified Polyolefin.
- 12 Modified Fluoro-elastomer.
- 25 Fluid resistant modified Elastomer.
- 100 Low fire hazard material.

Coatings available

- 3 & -4 /42 General purpose hot melt adhesive.
- /86 High performance hot melt adhesive.
- 25 /42 General purpose hot melt adhesive.
- /86 High performance hot melt adhesive.
- /225 Pre-coated curing adhesive.
- 100 /86 High performance hot melt adhesive.
- /180 Low fire hazard hot melt adhesive.

Dimensions (all dimensions are in mm's)

A) Dimensions as supplied (min)				B) Dimensions after heating recovery (max)									
H	J	J		H	J	P	R	U	JO	HW	JW		
						±10%	±10%	±10%	±10%	±20%	±20%		
Material*		-12 & 100											
Part Number												Weight	
222D921	19.3	6.3	4.5	13.0	2.1	44.5	16.3	5.6	21.8	1.52	1.14	1.9g	
222D932	26.1	7.6	5.6	19.1	2.6	67.3	18.0	8.4	29.2	1.78	1.14	3.7g	
222D953	34.2	9.6	6.6	26.0	3.0	81.3	18.8	11.4	36.3	1.78	1.14	6.4g	
222D963	43.6	11.4	7.8	34.1	3.6	115.6	21.3	15.5	47.0	1.78	1.14	13.0g	

Note: *Dimensions apply to all available materials, unless otherwise stated.

Ordering Information

- Standard colour: 0 = (Black).
- Size selection: To determine the size of the required moulded part, please refer to table.
- Modifications: -00 = Potting ports (Injection port as indicated above).
- Standard packaging: Moulded parts are individually packaged.
- Ordering description: Specify the product name, size, material, coating and modifications required.
- Ordering Example:** To fit a 14mm connector, using -25 material in black = **222D921-25-0**.
or using -3 material with hot melt adhesive = **222D921-3/42-0**.

Note: For a detailed description on how to construct your moulded part, please refer to the **Moulded Part Numbering Guide**. Larger sizes are also available on request, for more information please contact **IS-Rayfast**.